

PRW 10W

Asymmetrical light distribution
 Minimal design
 Integrated driver
 SDCM<3 CRI>90
 Dimming options available

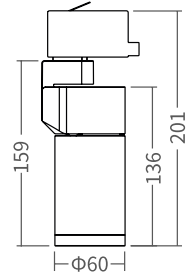

PRW .10W **NN** . **WAS** **B** **927**

Model Power Dimming Beam angle Body color CCT

Model
PRW

Beam angle
WAS 25x75 [°]

Power
10W [W]

Body color
B Black
W White

Dimming

NN none
DA Dali
1V 1-10V
PM Potentiometer
TR TRIAC

CCT
 927 2700K
 930 3000K
 940 4000K

Features

LED type	CREE
Standard CCT	2700K/3000K/4000K
Other CCT upon request	5000K/6000K
Beam angle	WAS 25x75°

Performance

Max. delivered output	657 – 760lm
Efficacy	66 – 76lm/W

Electrical and control

Supply type	Main voltage
Input voltage	AC240V
Max. power consumption	10W
Dimming option	See table of codes

Physical

Housing material	Aluminium
Optics material	PMMA
Weight	0.62kg
Operating temperature	-25/+55°C

