

# SUR 13

Ceiling mounted  
SDCM<3 CRI>90

**S13** . **15W** **090** **W** **IP20** **927**

Model Power Beam angle Body color IP grade CCT

**Model**  
SUR

**IP grade**  
IP20

**Power**  
15W [W]  
18W [W]

**CCT**  
927 2700K  
930 3000K  
940 4000K  
950 5000K

**Beam angle**  
090 [°]

**Body color**  
W White

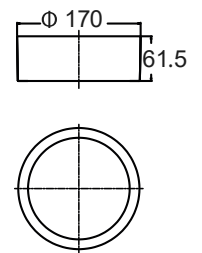

## Features

LED type	CREE
Color and CCT	2700K/3000K/4000K/5000K
Other colors	Upon request
Beam angle	90°

## Performance

Max. delivered output	1400lm (15W) / 1800lm (18W)
Efficacy	93lm/W (15W) / 100lm/W (18W)

## Electrical and control

Supply type	Main voltage (Integral LED driver)
Input voltage	AC240V
Max. power consumption	15W/18W
Dimming	Upon request

## Physical

Cut out	N.A.
Housing material	Aluminium
Optics material	PMMA
Weight	-
Operating temperature	-25/+55°C

